

Central Brass Company, Inc.  
3325 S. Garfield Ave.  
Commerce, CA 90040  
(800) 321-8630  
www.centralbrass.com

### Tools:



Adjustable Wrench



Teflon Tape



Pipe Cutter



Propane Torch



Lead-Free Solder



Power Drill

### Model Number: 0471-RC

#### Warnings and Notes:

Check with local plumbing code requirements before installation.  
This product should be installed by a local listed plumber.

**Do not use plumbers putty on threads.**



### Installation Steps:

Two Handle Laundry Faucet

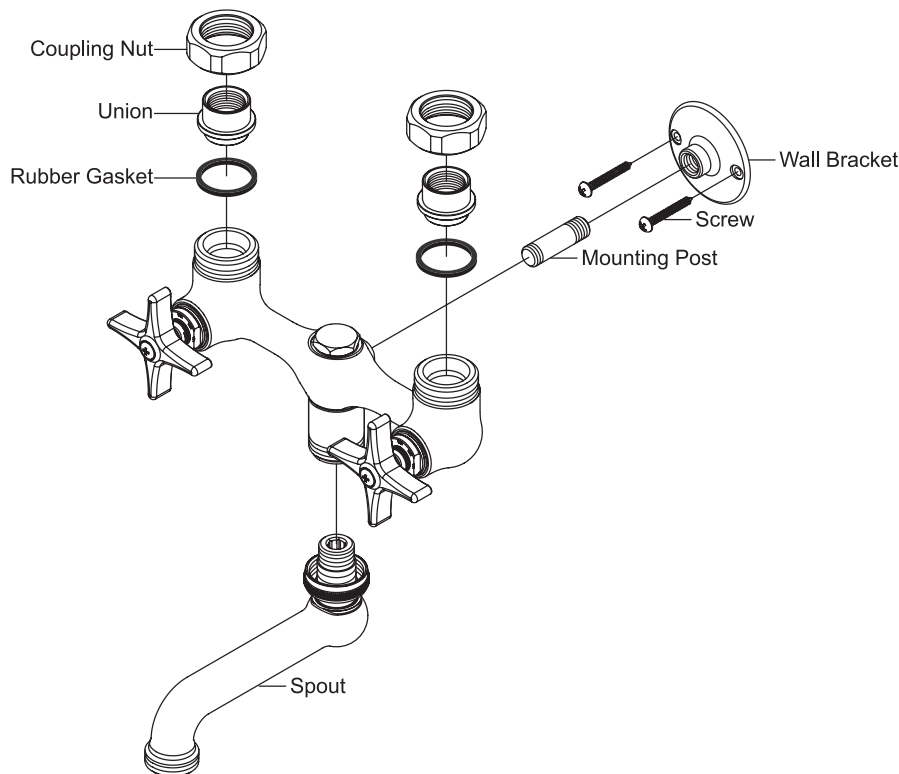

- (1) Measure the proper place to mount the wall bracket then drill two 3/32" holes for wall bracket's screw holes.
- (2) Screw the shorter thread end of mounting post into faucet body then screw wall bracket to the other end of mounting post. Carefully screw the spout straight into the faucet spout hole to avoid jamming spout O-ring, tightly screw on spout nut.
- (3) Slide coupling nut onto inlet pipe, apply Teflon tape at thread end if it has threaded connections, connect union to inlet pipe. **Place washer in between the bottom of the tailpiece union and valve inlet hole, screw and tighten tailpiece locknut to the valve body with the help of pipe wrench to form water tight seal.** Apply Teflon tape onto the thread end of the plug, screw & tighten plug onto the bottom of faucet's center hole with the help of a wrench. Install inlet connections. Screw in the two screws to hold wall bracket secure.