

## FOOT ACTUATED Tub Trim Kits

### SPECIFICATIONS

#### FEATURES:

- Brass strainer body.
- Metal overflow plate, 3.375" wide
- Designed for heavy-duty use in hotels, motels, and rental properties.
- Replaceable drip-proof Buna-N-Seal.
- Adapter bar for changing from two to one-hole overflow plate

#### PATENTS (QuickTrim):

- See <http://watcomfg.com/Watco/patents/> for Details

#### OPERATION:

- Step on stopper to open or close.

#### THREAD SIZE:

- Replacement sizes to fit most bath wastes.



## QuickTrim™ Kit For the FOOT ACTUATED:



See QuickTrim™ spec sheet for more details.

| QuickTrim® FA Trim Kit: | 69290 |
|-------------------------|-------|
| CP - Chrome Plated      | •     |
| AB - Antique Brass      |       |
| AP - Aged Pewter        |       |
| BB - Brushed Bronze     |       |
| BN - Brushed Nickel     | •     |
| BO - Bone               |       |
| BS - Biscuit            |       |
| BZ - Oil-Rubbed Bronze  | •     |
| CB - Chrome Brushed     |       |
| NP - Nickel Polished    | •     |
| PB - Polished Brass     | •     |
| WH - White              |       |
| WI - Wrought Iron       |       |

For More Information Contact:  
**WATCO Manufacturing Company**  
 1220 South Powell Road  
 Independence, MO 64057-2724  
 Ph. 816-796-3900 • FAX 816-796-0875  
 ® [www.watcomfg.com](http://www.watcomfg.com)

See price list for complete item numbers and available options.

When ordering, please specify complete item number and any applicable option codes.



# FOOT ACTUATED TRIM KIT PARTS LIST

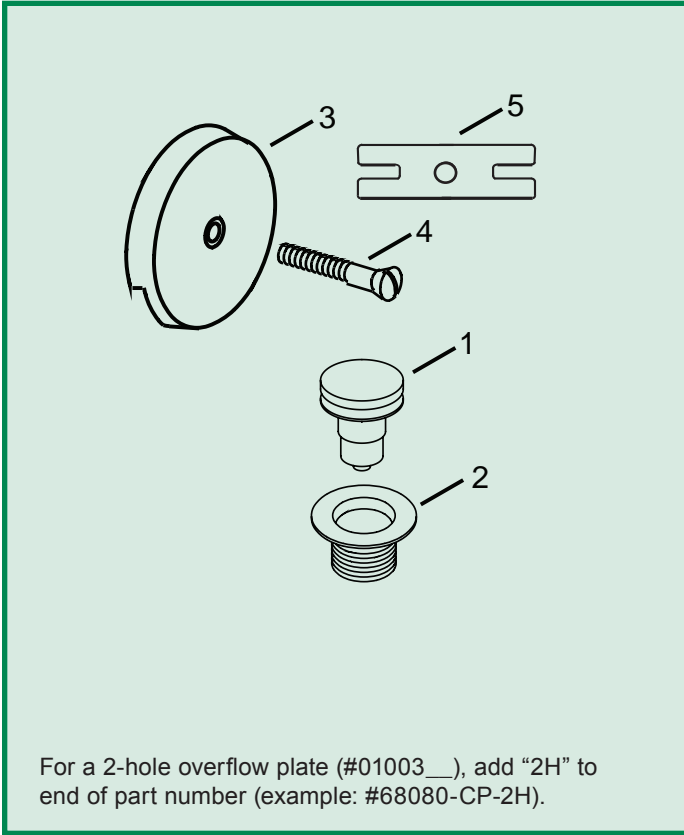

| Item                                   | Part #      | Description                                 |
|--|-------------|---|
| <b>WITH COARSE-THREAD (11.5) BODY:</b> |             |   |
| 1.                                     | 38412__.... | Foot Actuated stopper                       |
| 2.                                     | 01016__.... | Strainer Body, Brass, CT: 1.865"-11.5-1.25" |
| 3.                                     | 01002__.... | 1-Hole Overflow Plate, metal                |
| 4.                                     | 01024__.... | Overflow Plate Screw, Brass, 2.25"          |
| 5.                                     | 11641 ..... | Adapter Bar, aluminum                       |
| <b>WITH FINE-THREAD (16) BODY:</b>     |             |   |
| 1.                                     | 38412__.... | Foot Actuated stopper                       |
| 2.                                     | 01022__.... | Strainer Body, Brass, FT: 1.625"-16-1.25"   |
| 3.                                     | 01002__.... | 1-Hole Overflow Plate, metal                |
| 4.                                     | 01024__.... | Overflow Plate Screw, Brass, 2.25"          |
| 5.                                     | 11641 ..... | Adapter Bar, aluminum                       |
| __ Please indicate desired finish.     |             |   |

## Finishes Available in the Foot Actuated Series:

| Trim Kits:             | 68080 | 68190 | 68290 | 68390 | 68490 |
|------------------------|-------|-------|-------|-------|-------|
| CP - Chrome Plated     | ●     | ●     | ●     | ●     | ●     |
| AB - Antique Brass     |       |       |       |       |       |
| AP - Aged Pewter       |       |       |       |       |       |
| BB - Brushed Bronze    |       |       |       |       |       |
| BN - Brushed Nickel    | ●     | ●     | ●     | ●     |       |
| BO - Bone              |       |       |       |       |       |
| BS - Biscuit           |       |       |       |       |       |
| BZ - Oil-Rubbed Bronze | ●     | ●     | ●     | ●     |       |
| CB - Chrome Brushed    |       |       |       |       |       |
| NP - Nickel Polished   | ●     | ●     | ●     | ●     |       |
| PB - Polished Brass    | ●     | ●     | ●     | ●     | ●     |
| WH - White             |       |       |       |       |       |
| WI - Wrought Iron      |       |       |       |       |       |



For More Information Contact:  
**WATCO Manufacturing Company**  
 1220 South Powell Road  
 Independence, MO 64057-2724  
 Ph. 816-796-3900 • FAX 816-796-0875  
[www.watcomfg.com](http://www.watcomfg.com)