

Job Name _____

Contractor _____

Job Location _____

Approval _____

Engineer _____

Contractor's P.O. No. _____

Approval _____

Representative _____

LEAD FREE*

AquaLock™

AquaLock™ Mini Couplings and Adapters

Watts AquaLock push-to-connect Couplings and Adapters are designed and manufactured for many years of trouble free service. Produced of off white polypropylene, a high performance thermoplastic material, the Watts AquaLock design allows for quick and easy connections without the use of installation tools.

Specifications

Connection shall be made using Watts AquaLock Mini fitting with Integral Collet and O-Ring guide. Fitting shall be able to fully rotate under pressure and allow easy disconnect and reuse without the use of disconnection tools. Fitting must not disassemble to disconnect.

Approvals

- Listed by the National Sanitation Foundation to NSF standard 61 for use in potable water systems

Ratings

150psi @ 70°F (10 bar @ 20°C)

60psi @ 140°F (4 bar @ 60°C) Min. 33°F (1°C)

Example

1014R-0604

10 = Mini

14 = Reducing Stem

R = Reducing

0604 = 3/8" OD x 1/4" OD



1001



1015



1010



1015R



1014R



1027



CAUTION

The polypropylene material used in the AquaLock™ fittings can be compromised by exposure to volatile organic compounds (VOC's) and caustic chemicals. Therefore, **DO NOT** expose this product to any such chemical or foreign substance, which would include exposure to the following products: **Pipe Dopes (thread sealants)**, bug sprays, lubricants, cleaners, paints, bleaches, acids, solder fluxes, plastic piping primers and cements, oxidizing agents, alkaline solutions, thinners, fuels, oil based caulks, hydrocarbons, spray foam or foaming agents (insulation).

NOTICE

The information contained herein is not intended to replace the full product installation and safety information available or the experience of a trained product installer. You are required to thoroughly read all installation instructions and product safety information before beginning the installation of this product.

***The wetted surface of this product contacted by consumable water contains less than 0.25% of lead by weight.**

Dimensions – Weights approx. (tolerance +/- 1/8")

Male Adapter

MODEL	ORDERING CODE	SIZE & CONNECTION	ITEM LENGTH		ITEM HEIGHT		ITEM WEIGHT	
			A		B		oz.	gr.
			in.	mm	in.	mm		
1001-0402	17103004	1/4" OD x 1/8" NPTF	1 1/16	26	1 3/16	20	0.20	5.67
1001-0404	17103005	1/4" OD x 1/4" NPTF	1 3/16	30	1 3/16	20	0.20	5.67
1001-0406	17103006	1/4" OD x 3/8" NPTF	1 3/16	30	1 3/16	20	0.20	5.67
1001-0408	17103007	1/4" OD x 1/2" NPTF	1 1/2	37	1 3/16	21	0.30	8.50
1001-0602	17103024	3/8" OD x 1/8" NPTF	1 7/16	36	1 3/16	21	0.21	5.90
1001-0604	17103025	3/8" OD x 1/4" NPTF	1 9/16	39	1 3/16	21	0.30	8.50
1001-0606	17103026	3/8" OD x 3/8" NPTF	1 9/16	39	1 3/16	21	0.30	8.50
1001-0608	17103027	3/8" OD x 1/2" NPTF	1 11/16	43	1 3/16	21	0.30	8.50
1001-0806	17103035	1/2" OD x 3/8" NPTF	1 11/16	41	1	25	0.40	11.34
1001-0808	17103036	1/2" OD x 1/2" NPTF	1 13/16	45	1	25	0.40	11.34

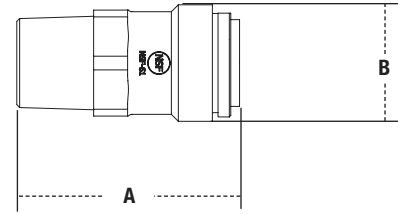

Female Adapter

MODEL	ORDERING CODE	SIZE & CONNECTION	ITEM LENGTH		ITEM HEIGHT		ITEM WEIGHT	
			A		B		oz.	gr.
			in.	mm	in.	mm		
1010-0401	0666147	1/4" OD x 7/16" UNS	1 1/2	38	7/8	22	0.32	9.07
1010-0601	0666148	3/8" OD x 7/16" UNS	1 9/16	39	7/8	22	0.29	8.16
1010-0404	17103060	1/4" OD x 1/4" NPTF	1 1/2	38	7/8	22	0.29	8.16
1010-0604	17103065	3/8" OD x 1/4" NPTF	1 9/16	39	7/8	22	0.24	6.80

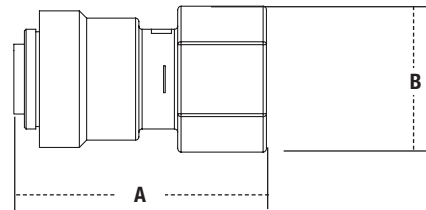

Reducing Stems

MODEL	ORDERING CODE	SIZE & CONNECTION	ITEM LENGTH		ITEM HEIGHT		ITEM WEIGHT	
			A		B		oz.	gr.
			in.	mm	in.	mm		
1014R-0604	0666145	3/8" OD x 1/4" OD	1 3/4	43	1 1/16	16	0.20	5.67

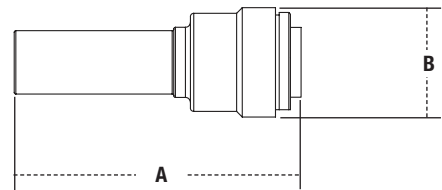

Coupling

MODEL	ORDERING CODE	SIZE & CONNECTION	ITEM LENGTH		ITEM HEIGHT		ITEM WEIGHT	
			A		B		oz.	gr.
			in.	mm	in.	mm		
1015-04	17103000	1/4" OD	1 5/8	41	1 1/16	16	0.20	5.67
1015-06	17103020	3/8" OD	1 15/16	49	1 3/16	21	0.30	8.50
1015-08	17103030	1/2" OD	2 1/4	56	1"	24	0.50	14.17

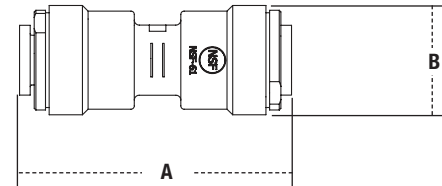

Reducing Coupling

MODEL	ORDERING CODE	SIZE & CONNECTION	ITEM LENGTH		ITEM HEIGHT		ITEM WEIGHT	
			A		B		oz.	gr.
			in.	mm	in.	mm		
1015R-0604	17103021	3/8" OD x 1/4" OD	1 7/8	48	1 3/16	21	0.30	8.50
1015R-0806	17103031	1/2" OD x 3/8" OD	2 1/4	56	1"	24	0.51	14.51

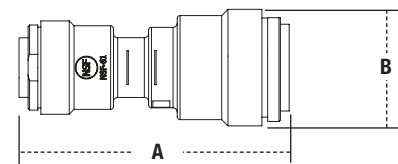

Male Stem

MODEL	ORDERING CODE	SIZE & CONNECTION	ITEM LENGTH		ITEM HEIGHT		ITEM WEIGHT	
			A		B		oz.	gr.
			in.	mm	in.	mm		
1027-0402	0666104	1/4" OD x 1/8" NPTF	1 13/16	46	1 3/16	20	0.20	5.67
1027-0604	0666106	3/8" OD x 1/4" NPTF	2 9/16	65	1 3/16	21	0.30	8.50
1027-0606	0666107	3/8" OD x 3/8" NPTF	2 9/16	65	1 3/16	21	0.30	8.62
1027-0806	0666108	1/2" OD x 3/8" NPTF	2 3/4"	69	1"	26	0.42	11.79

